

CR, CRI, CRN 1s, 1, 3, 5, 10, 15, 20

CR, CRN 32, 45, 64, 90, 120, 150

Double seal (back-to-back)

Installation and operating instructions

GB D F I E P GR NL S FIN DK PL RU H SI HR
SER RO BG CZ SK TR EE LT LV ZH JP KO



**CR, CRI, CRN 1s, 1, 3, 5, 10, 15, 20
CR, CRN 32, 45, 64, 90, 120, 150
Double seal (back-to-back)**

Installation and operating instructions	4	GB
Montage- und Betriebsanleitung	10	D
Notice d'installation et de fonctionnement	17	F
Istruzioni di installazione e funzionamento	24	I
Instrucciones de instalación y funcionamiento	30	E
Instruções de instalação e funcionamento	36	P
Οδηγίες εγκατάστασης και λειτουργίας	43	GR
Installatie- en bedieningsinstructies	49	NL
Monterings- och driftsinstruktion	55	S
Asennus- ja käyttöohjeet	61	FIN
Monterings- og driftsinstruktion	67	DK
Instrukcja montażu i eksploatacji	73	PL
Руководство по монтажу и эксплуатации	80	RU
Szerelési és üzemeltetési utasítás	87	H
Navodila za montažo in obratovanje	94	SI
Montažne i pogonske upute	101	HR
Uputstvo za instalaciju i rad	108	SER
Instrucțiuni de instalare și utilizare	115	RO
Упътване за монтаж и експлоатация	121	BG
Montážní a provozní návod	128	CZ
Návod na montáž a prevádzku	135	SK
Montaj ve kullanım kılavuzu	142	TR
Paigaldus- ja kasutusjuhend	149	EE
Įrengimo ir naudojimo instrukcija	155	LT
Uzstādīšanas un ekspluatācijas instrukcija	161	LV
安装和使用说明书	167	ZH
据付・運転・保守に関する取扱説明書	173	JP
설치 및 작동 지침	179	KO

CONTENTS

	Page
1. Symbols used in this document	4
2. General information	4
3. Product description	4
4. Applications	4
5. Maximum liquid pressure and temperature	4
6. Barrier fluid connections	4
7. Pump with pressure intensifier	6
7.1 Components of pressure intensifier	6
7.2 Dimensions of pump with pressure intensifier	6
8. Pump with dosing pump	6
9. Start-up	7
9.1 Pump with pressure intensifier	7
9.2 Pump with dosing pump	8
10. Maintenance	9
11. Operation	9
11.1 Frost protection	9
12. Disposal	9



Prior to installation, read these installation and operating instructions. Installation and operation must comply with local regulations and accepted codes of good practice.

1. Symbols used in this document



Warning
If these safety instructions are not observed, it may result in personal injury!

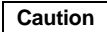

Caution
If these safety instructions are not observed, it may result in malfunction or damage to the equipment!

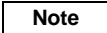

Note
Notes or instructions that make the job easier and ensure safe operation.

2. General information

These installation and operating instructions are a supplement to installation and operating instructions for standard CR, CRI, CRN pumps, publication No 96462123, and for CRN-SF pumps, publication No 96530119.

3. Product description

This type of double seal consists of two shaft seals mounted in a "back-to-back" arrangement in a separate seal chamber. The pressure in the seal chamber is higher than the pump pressure. The double seal arrangement with pressurised seal chamber prevents the pumped liquid from leaking to the environment via the shaft seal.

The pressure in the seal chamber can be generated in three ways:

- by means of a pressure intensifier (section 9.1)
- by means of a dosing pump (section 9.2)
- by means of an already existing system.

4. Applications

The shaft seal is available for the following Grundfos pumps:

Pump type	CR 1s	CR 1	CR 3	CR 5	CR 10	CR 15	CR 20	CR 32	CR 45	CR 64	CR 90	CR 120	CR 150
CR	•	•	•	•	•	•	•	•	•	•	•	•	•
CRI	•	•	•	•	•	•	•						
CRN	•	•	•	•	•	•	•	•	•	•	•	•	•

This type of shaft seal is the optimum solution when handling abrasive or sticky liquids which would either wear out, damage or block a mechanical shaft seal.

Recommended for applications involving toxic, aggressive or flammable liquids, the seal shaft protects the surrounding environment and the people working in the vicinity of the pump.



If the shaft seal is used in applications where special safety precautions must be observed due to hazardous liquids, the customer bears full responsibility!

5. Maximum liquid pressure and temperature

Due to the shaft seal design, the pressure in the seal chamber must not exceed 25 bar. The pressure of the barrier fluid must always be higher than the pressure of the pumped liquid.

The maximum temperature of the barrier fluid depends on the rubber material of the shaft seal.

Shaft seal	Maximum temperature [°C]
EPDM	+120
FKM	+90
FFKM	+120
FXM	+120

6. Barrier fluid connections

Key to the letters in the drawings:

Pos. A = pumped liquid.

Pos. C/D and E = barrier fluid.

Figures 1, 2, 3 and 4 show where to fit a sensor (pos. A), if retrofitted.

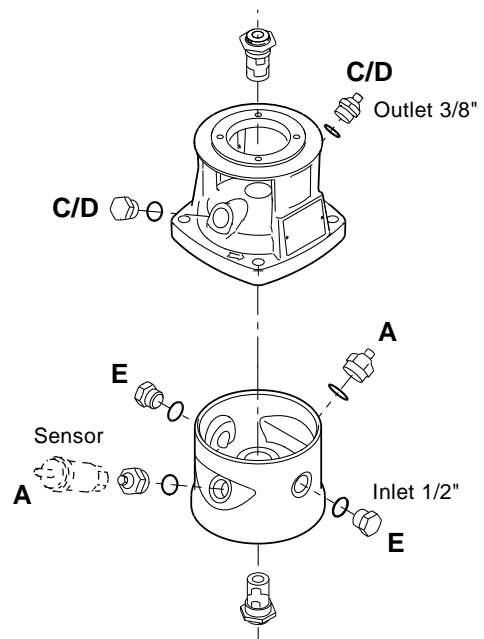

Fig. 1 Seal chamber CR, CRI, CRN 1s, 1, 3, 5

TM04 3225 3908

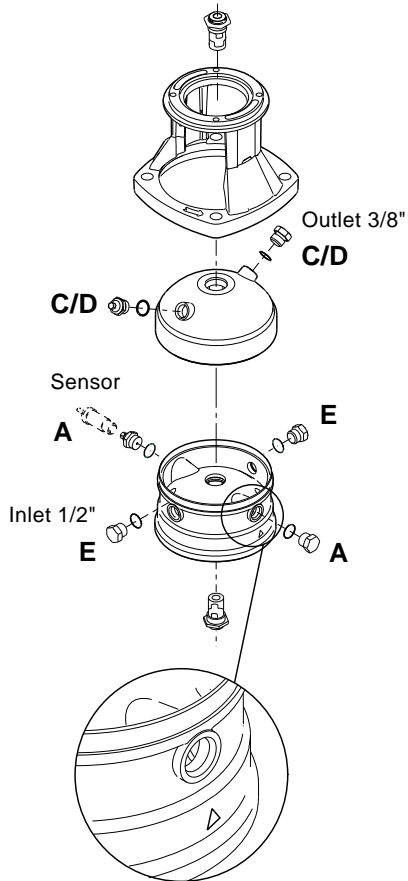

Fig. 2 Seal chamber CR, CRI, CRN 10, 15, 20

TM04 3226 3908

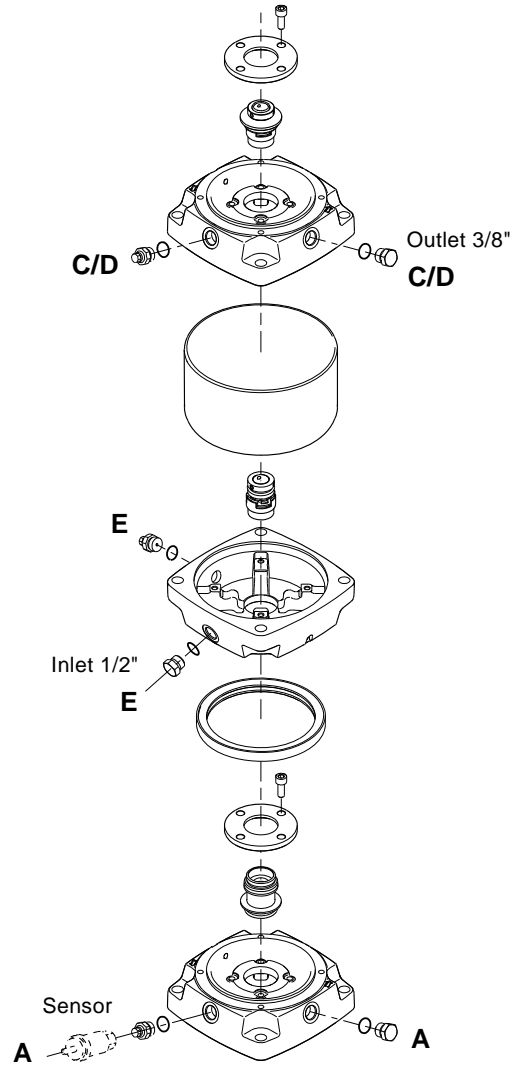

Fig. 3 Seal chamber CR, CRN 32, 45, 64, 90

TM03 8269 3308

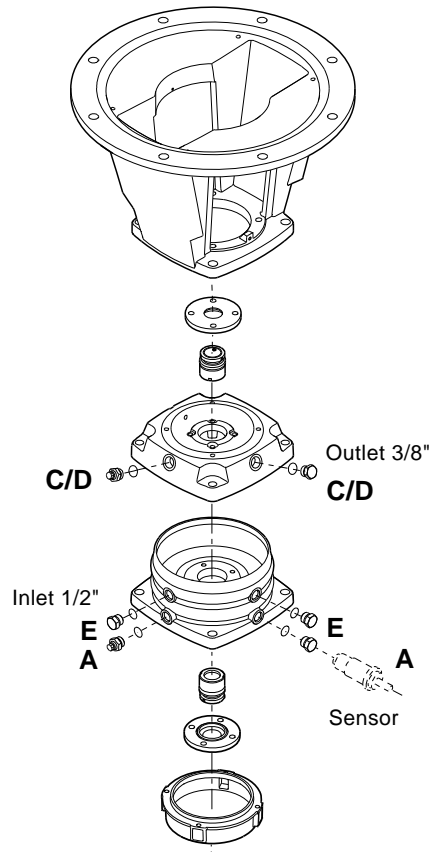

Fig. 4 Seal chamber CR, CRN 120, 150

TM04 4080 0909

7. Pump with pressure intensifier

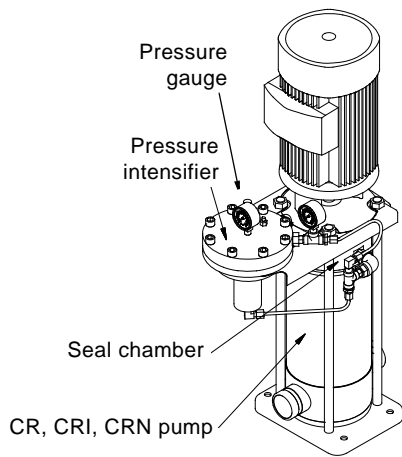

Fig. 5 Pump with pressure intensifier

7.1 Components of pressure intensifier

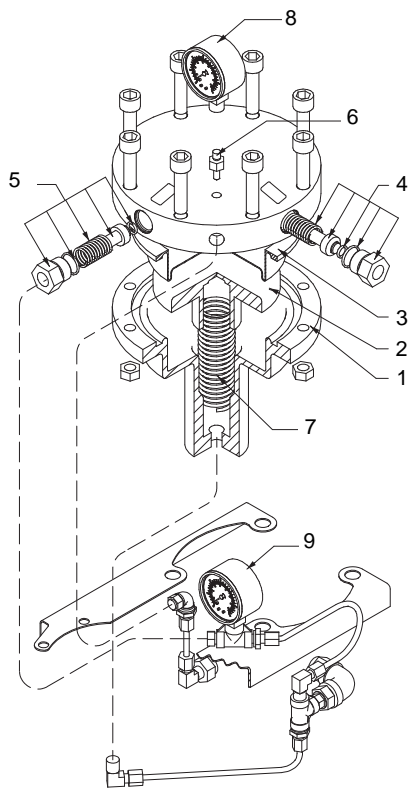

Fig. 6 Components of pressure intensifier

Pos.	Designation
1	Pressure intensifier
2	Piston
3	Diaphragm
4	Non-return valve
5	Relief valve
6	Vent screw, Rp 1/8
7	Spring for piston
8	Pressure gauge (barrier fluid)
9	Pressure gauge (pumped liquid)

TM01 4455 0399

TM03 8299 1007

7.2 Dimensions of pump with pressure intensifier

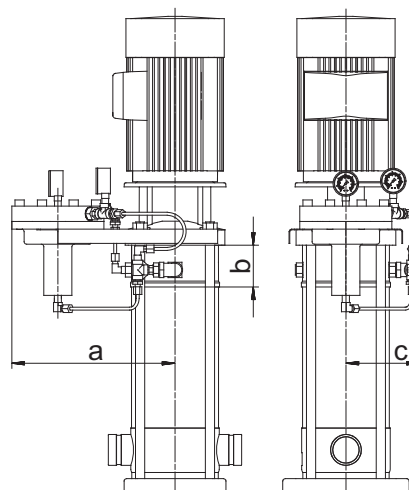

Fig. 7 Pump with pressure intensifier

Pump type	a [mm]	b [mm]	c [mm]
CR, CRI, CRN 1s, 1, 3, 5	297	108	128
CR, CRI, CRN 10, 15, 20	234	90	140
CR, CRN 32	342	210	155
CR, CRN 45	349	240	164
CR, CRN 64	349	166	164
CR, CRN 90	355	184	170
CR, CRN 120, 150	355	111	170

The dimension **b** is the additional height compared to the standard pump.

8. Pump with dosing pump

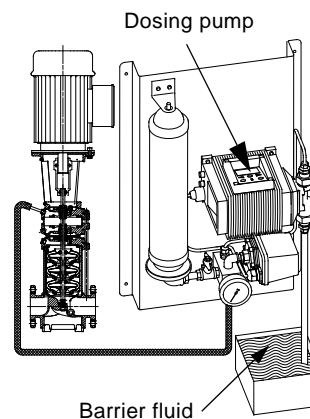

Fig. 8 Pump with dosing pump

8.0.1 Dimensions of pump with dosing pump

Pump type	Additional height of seal chamber [mm]
CR, CRI, CRN 1s, 1, 3, 5	108
CR, CRI, CRN 10, 15, 20	90
CR, CRN 32	210
CR, CRN 45	240
CR, CRN 64	166
CR 90	184
CR, CRN 120, 150	111

TM01 4459 0399

TM01 9099 1701

9. Start-up

9.1 Pump with pressure intensifier



Warning

Pay attention to the orientation of the vent holes, and take care to ensure that the escaping liquid does not cause personal injury or damage to the motor or other components.

When handling hot or hazardous liquids, special attention should be paid to the risk of personal injury.

When pumping flammable liquids, beware of static discharges. The funnel, for instance, should be earthed!

Illustration	Step	Action
	1	<p>Operation with positive inlet pressure</p> <ul style="list-style-type: none"> Open the vent screw (pos. A, fig. 1, 2, 3 or 4) on the side of the pump head. Close the isolating valve on the discharge side. Open the isolating valve on the inlet side. Slowly fill the pump with the liquid to be pumped. When the liquid starts running out of the vent hole, immediately close the vent screw. <p>Operation with suction lift</p> <ul style="list-style-type: none"> Open the vent screw (pos. A, fig. 1, 2, 3 or 4) on the side of the pump head. Close the isolating valve on the discharge side. Fill the pump and the inlet pipe with the liquid to be pumped using a funnel. When the liquid starts running out of the vent hole, immediately close the vent screw. <p>Note: A non-return valve must be fitted to the inlet pipe.</p>
	2	<p>Filling the seal chamber</p> <ul style="list-style-type: none"> Fill the intensifier and the seal chamber with barrier fluid, and connect the barrier fluid supply pipe to the unused inlet of the intensifier (pos. 4, fig. 6). The pressure in the seal chamber must always be 1.5 to 4 bar higher than the pump pressure when the pump is not operating. <p>$p_f = p_s^* + 1.5 \text{ to } 4 \text{ bar}$.</p> <p>$p_f$ = To be read on the pressure gauge on the intensifier (pos. 8, fig. 6). p_s = To be read on the pressure gauge in the connection pipe (pos. 9, fig. 6) between intensifier and pump.</p> <p>* p_s = inlet pressure when the pump is not operating; must always be 0.1 to 5 bar higher than the atmospheric pressure.</p>
	3	<p>Venting</p> <p>During filling, the seal chamber and the intensifier must be vented:</p> <ul style="list-style-type: none"> Use the vent screw at the top of the seal chamber (pos. C/D, fig. 1, 2, 3 or 4) and the vent screw at the top of the intensifier (pos. 6, fig. 6).
	4	<p>Disconnecting the barrier fluid supply pipe</p> <ul style="list-style-type: none"> Disconnect the barrier fluid supply pipe from the intensifier.
	5	<p>Starting up the pump</p> <ul style="list-style-type: none"> See also the installation and operating instructions for standard CR, CRI, CRN pumps. Start the pump, and check the direction of rotation. See the correct direction of rotation on the motor fan cover. After a few minutes, vent the pump again by means of the vent screw (pos. A, fig. 1, 2, 3 or 4).

9.2 Pump with dosing pump



Warning

Pay attention to the orientation of the vent holes, and take care to ensure that the escaping liquid does not cause personal injury or damage to the motor or other components.

When handling hot or hazardous liquids, special attention should be paid to the risk of personal injury.

When pumping flammable liquids, beware of static discharges. The funnel, for instance, should be earthed!

GB

Illustration	Step Action
	<p>1 Connecting the barrier fluid supply pipe</p> <ul style="list-style-type: none"> Connect one end to the seal chamber (pos. E, fig. 1, 2, 3 or 4). Connect the other end to the outlet of the dosing pump.
	<p>2 Recommended pressure</p> <ul style="list-style-type: none"> Set the start pressure of the dosing pump to a pressure 1.5 to 2 bar above the highest pressure the pump can deliver. ($P_{\text{pump}} + P_{\text{inlet}} + P_{1.5 - 2.0} < P_{\text{dosing max.}}$)
	<p>3 Filling and venting the seal chamber</p> <ul style="list-style-type: none"> Start the dosing pump. Fill and vent the seal chamber by means of the vent screw at the top of the seal chamber (pos. C/D, fig. 1, 2, 3 or 4). The dosing pump will stop automatically when the pressure set in step 2 has been reached.
	<p>4 Operation with positive inlet pressure</p> <ul style="list-style-type: none"> Open the vent screw (pos. A, fig. 1, 2, 3 or 4) on the side of the pump head. Close the isolating valve on the discharge side. Open the isolating valve on the inlet side. Slowly fill the pump with the liquid to be pumped. When the liquid starts running out of the vent hole, immediately close the vent screw.
	<p>4 Operation with suction lift</p> <ul style="list-style-type: none"> Open the vent screw (pos. A, fig. 1, 2, 3 or 4) on the side of the pump head. Close the isolating valve on the discharge side. Fill the pump and the inlet pipe with the liquid to be pumped using a funnel. When the liquid starts running out of the vent hole, immediately close the vent screw. <p>Note: A non-return valve must be fitted to the inlet pipe.</p>
	<p>5 Starting up the pump</p> <ul style="list-style-type: none"> See also the installation and operating instructions for standard CR, CRI, CRN pumps. Open the isolating valve on the discharge side. Start the pump, and check the direction of rotation. See the correct direction of rotation on the motor fan cover. After a few minutes, vent the pump again by means of the air vent screw (pos. A, fig. 1, 2, 3 or 4).

10. Maintenance

See the installation and operating instructions for standard CR, CRI, CRN pumps.

Pressure intensifier

The pressure intensifier is maintenance-free.

Dosing pump

See the installation and operating instructions for the dosing pump.

11. Operation

To ensure optimum function and performance, check the pressure regularly.

Pressure intensifier

The pressure difference between the two pressure gauges (seal chamber and pump) must be between 1 and 1.5 bar. This indicates that the seal chamber contains sufficient barrier fluid.

Dosing pump

The pressure of the barrier fluid must always be 1.5 to 2 bar higher than the pressure of the pumped liquid. This is automatically checked by the pressure switch/ transmitter fitted together with the dosing pump.

Note

A very small quantity of the barrier fluid, i.e. less than 10 ml/24 operating hours, will always flow into the pumped liquid.

11.1 Frost protection

For general guidelines on frost protection of the pump, see the installation and operating instructions for standard CR, CRI, CRN pumps.

Seal chamber

Drain the seal chamber by slackening the lower plug (pos. E, figures 1, 2, 3 or 4).

Pressure intensifier

Replace the barrier fluid by antifreeze liquid.

Dosing pump

For frost protection, see the installation and operating instructions for the dosing pump.



Warning

If the pumped liquid is hazardous to health, take special care when draining the pump. Local safety regulations must be observed.

12. Disposal

This product or parts of it must be disposed of in an environmentally sound way:

1. Use the public or private waste collection service.
2. If this is not possible, contact the nearest Grundfos company or service workshop.

Argentina
Bombas GRUNDFOS de Argentina S.A.
Ruta Panamericana km. 37.500 Lote 34A
1619 - Garin
Pcia. de Buenos Aires
Phone: +54-3327 414 444
Telefax: +54-3327 411 111

Australia
GRUNDFOS Pumps Pty. Ltd.
P.O. Box 2040
Regency Park
South Australia 5942
Phone: +61-8-8461-4611
Telefax: +61-8-8340 0155

Austria
GRUNDFOS Pumpen Vertrieb Ges.m.b.H.
Grundfosstraße 2
A-5082 Grödig/Salzburg
Tel.: +43-6246-883-0
Telefax: +43-6246-883-30

Belgium
N.V. GRUNDFOS Bellux S.A.
Boomsesteenweg 81-83
B-2630 Aartselaar
Tel.: +32-3-870 7300
Télécopie: +32-3-870 7301

Belorussia
Представительство ГРУНДФОС в
Минске
220123, Минск,
ул. В. Хоружей, 22, оф. 1105
Тел.: +(37517) 233 97 65,
Факс: +(37517) 233 97 69
E-mail: grundfos_minsk@mail.ru

Bosnia/Herzegovina
GRUNDFOS Sarajevo
Trg Heroja 16,
BiH-71000 Sarajevo
Phone: +387 33 713 290
Telefax: +387 33 659 079
e-mail: grundfos@bih.net.ba

Brazil
Mark GRUNDFOS Ltda.
Av. Humberto de Alencar Castelo Branco,
630
CEP 09850 - 300
São Bernardo do Campo - SP
Phone: +55-11 4393 5533
Telefax: +55-11 4343 5015

Bulgaria
GRUNDFOS Pumpen Vertrieb
Representative Office - Bulgaria
Bulgaria, 1421 Sofia
Lozenetz District
105-107 Arsenalski blvd.
Phone: +359 2963 3820, 2963 5653
Telefax: +359 2963 1305

Canada
GRUNDFOS Canada Inc.
2941 Brighton Road
Oakville, Ontario
L6H 6C9
Phone: +1-905 829 9533
Telefax: +1-905 829 9512

China
GRUNDFOS Pumps (Shanghai) Co. Ltd.
51 Floor, Raffles City
No. 268 Xi Zang Road. (M)
Shanghai 200001
PRC
Phone: +86-021-612 252 22
Telefax: +86-021-612 253 33

Croatia
GRUNDFOS CROATIA d.o.o.
Cebini 37, Buzin
HR-10010 Zagreb
Phone: +385 1 6595 400
Telefax: +385 1 6595 499
www.grundfos.hr

Czech Republic
GRUNDFOS s.r.o.
Čajkovského 21
779 00 Olomouc
Phone: +420-585-716 111
Telefax: +420-585-716 299

Denmark
GRUNDFOS DK A/S
Martin Bachs Vej 3
DK-8850 Bjerringbro
Tlf.: +45-87 50 50 50
Telefax: +45-87 50 51 51
E-mail: info_GDK@grundfos.com
www.grundfos.com/DK

Estonia
GRUNDFOS Pumps Eesti OÜ
Peterburi tee 92G
11415 Tallinn
Tel: + 372 606 1690
Fax: + 372 606 1691

Finland
OY GRUNDFOS Pumput AB
Mestarintie 11
FIN-01730 Vantaa
Phone: +358-3066 5650
Telefax: +358-3066 56550

France
Pompes GRUNDFOS Distribution S.A.
Parc d'Activités de Chesnes
57, rue de Malacombe
F-38290 St. Quentin Fallavier (Lyon)
Tél.: +33-4 74 82 15 15
Télécopie: +33-4 74 94 10 51

Germany
GRUNDFOS GMBH
Schlüterstr. 33
40699 Erkrath
Tel.: +49-(0) 211 929 69-0
Telefax: +49-(0) 211 929 69-3799
e-mail: infoservice@grundfos.de
Service in Deutschland:
e-mail: kundendienst@grundfos.de

Greece
GRUNDFOS Hellas A.E.B.E.
20th km. Athinon-Markopoulou Av.
P.O. Box 71
GR-19002 Peania
Phone: +0030-210-66 83 400
Telefax: +0030-210-66 46 273

Hong Kong
GRUNDFOS Pumps (Hong Kong) Ltd.
Unit 1, Ground floor
Siu Wai Industrial Centre
29-33 Wing Hong Street &
68 King Lam Street, Cheung Sha Wan
Kowloon
Phone: +852-27861706 / 27861741
Telefax: +852-27858664

Hungary
GRUNDFOS Hungária Kft.
Park u. 8
H-2045 Törökbálint,
Phone: +36-23 511 110
Telefax: +36-23 511 111

India
GRUNDFOS Pumps India Private Limited
118 Old Mahabalipuram Road
Thoraiakkam
Chennai 600 096
Phone: +91-44 2496 6800

Indonesia
PT GRUNDFOS Pompa
Jl. Rawa Sumur III, Blok III / CC-1
Kawasan Industri, Pulogadung
Jakarta 13930
Phone: +62-21-460 6909
Telefax: +62-21-460 6910 / 460 6901

Ireland
GRUNDFOS (Ireland) Ltd.
Unit A, Merrywell Business Park
Ballymount Road Lower
Dublin 12
Phone: +353-1-4089 800
Telefax: +353-1-4089 830

Italy
GRUNDFOS Pompe Italia S.r.l.
Via Gran Sasso 4
I-20060 Truccazzano (Milano)
Tel.: +39-02-95838112
Telefax: +39-02-95309290 / 95838461

Japan
GRUNDFOS Pumps K.K.
Gotanda Metalion Bldg., 5F,
5-21-15, Higashi-gotanda
Shiagawa-ku, Tokyo
141-0022 Japan
Phone: +81 35 448 1391
Telefax: +81 35 448 9619

Korea
GRUNDFOS Pumps Korea Ltd.
6th Floor, Aju Building 679-5
Yeoksam-dong, Kangnam-ku, 135-916
Seoul, Korea
Phone: +82-2-5317 600
Telefax: +82-2-5633 725

Latvia
SIA GRUNDFOS Pumps Latvia
Deglava biznesa centrs
Augusta Deglava ielā 60, LV-1035, Rīga,
Tālr.: + 371 714 9640, 7 149 641
Fakss: + 371 914 9646

Lithuania
GRUNDFOS Pumps UAB
Smolensko g. 6
LT-03201 Vilnius
Tel: + 370 52 395 430
Fax: + 370 52 395 431

Malaysia
GRUNDFOS Pumps Sdn. Bhd.
7 Jalan Peguam U1/25
Glenmarie Industrial Park
40150 Shah Alam
Selangor
Phone: +60-3-5569 2922
Telefax: +60-3-5569 2866

México
Bombas GRUNDFOS de México S.A. de
C.V.
Boulevard TLC No. 15
Parque Industrial Stiva Aeropuerto
Apodaca, N.L. 66600
Phone: +52-81-8144 4000
Telefax: +52-81-8144 4010

Netherlands
GRUNDFOS Netherlands
Veluwezoom 35
1326 AE Almere
Postbus 22015
1302 CA ALMERE
Tel.: +31-88-478 6336
Telefax: +31-88-478 6332
e-mail: info_gnl@grundfos.com

New Zealand
GRUNDFOS Pumps NZ Ltd.
17 Beatrice Tinsley Crescent
North Harbour Industrial Estate
Albany, Auckland
Phone: +64-9-415 3240
Telefax: +64-9-415 3250

Norway
GRUNDFOS Pumper A/S
Strømsveien 344
Postboks 235, Leirdal
N-1011 Oslo
Tlf.: +47-22 90 47 00
Telefax: +47-22 32 21 50

Poland
GRUNDFOS Pompy Sp. z o.o.
ul. Klonowa 23
Baranowo k. Poznania
PL-62-081 Przeźmierowo
Tel: (+48-61) 650 13 00
Fax: (+48-61) 650 13 50

Portugal
Bombas GRUNDFOS Portugal, S.A.
Rua Calvet de Magalhães, 241
Apartado 1079
P-2770-153 Paço de Arcos
Tel.: +351-21-440 76 00
Telefax: +351-21-440 76 90

România
GRUNDFOS Pompe România SRL
Bd. Biruintei, nr 103
Pantelimon county Ilfov
Phone: +40 21 200 4100
Telefax: +40 21 200 4101
E-mail: romania@grundfos.ro

Russia
ООО Грундфос
Россия, 109544 Москва, ул. Школьная
39
Тел. (+7) 495 737 30 00, 564 88 00
Факс (+7) 495 737 75 36, 564 88 11
E-mail grundfos.moscow@grundfos.com

Serbia
GRUNDFOS Predstavništvo Beograd
Dr. Milutina Ivkovića 2a/29
YU-11000 Beograd
Phone: +381 11 26 47 877 / 11 26 47 496
Telefax: +381 11 26 48 340

Singapore
GRUNDFOS (Singapore) Pte. Ltd.
24 Tuas West Road
Jurong Town
Singapore 638381
Phone: +65-6865 1222
Telefax: +65-6861 8402

Slovenia
GRUNDFOS PUMPEN VERTRIEB
Ges.m.b.H.,
Podružnica Ljubljana
Štandrova 8b, SI-1231 Ljubljana-Črnuče
Phone: +386 1 568 0610
Telefax: +386 1 568 0619
E-mail: slovenia@grundfos.si

Spain
Bombas GRUNDFOS España S.A.
Camino de la Fuentecilla, s/n
E-28110 Algete (Madrid)
Tel.: +34-91-848 8800
Telefax: +34-91-628 0465

Sweden
GRUNDFOS AB
Box 333 (Lunnagårdsgatan 6)
431 24 Mölndal
Tel.: +46(0)771-32 23 00
Telefax: +46(0)31-331 94 60

Switzerland
GRUNDFOS Pumpen AG
Bruggacherstrasse 10
CH-8117 Fällanden/ZH
Tel.: +41-1-806 8111
Telefax: +41-1-806 8115

Taiwan
GRUNDFOS Pumps (Taiwan) Ltd.
7 Floor, 219 Min-Chuan Road
Taichung, Taiwan, R.O.C.
Phone: +886-4-2305 0868
Telefax: +886-4-2305 0878

Thailand
GRUNDFOS (Thailand) Ltd.
92 Chaloen Phrakiat Rama 9 Road,
Dokmai, Pravej, Bangkok 10250
Phone: +66-2-725 8999
Telefax: +66-2-725 8998

Turkey
GRUNDFOS POMPA San. ve Tic. Ltd. Sti.
Gebze Organize Sanayi Bölgesi
Ihsan dede Caddesi,
2. yol 200. Sokak No. 204
41490 Gebze/ Kocaeli
Phone: +90 - 262-679 7979
Telefax: +90 - 262-679 7905
E-mail: satis@grundfos.com

Ukraine
ТОВ ГРУНДФОС УКРАЇНА
01010 Київ, Вул. Московська 86,
Тел.: (+38 044) 390 40 50
Факс.: (+38 044) 390 40 59
E-mail: ukraine@grundfos.com

United Arab Emirates
GRUNDFOS Gulf Distribution
P.O. Box 16768
Jebel Ali Free Zone
Dubai
Phone: +971-4- 8815 166
Telefax: +971-4-8815 136

United Kingdom
GRUNDFOS Pumps Ltd.
Grovebury Road
Leighton Buzzard/Beds. LU7 8TL
Phone: +44-1525-850000
Telefax: +44-1525-850011

U.S.A.
GRUNDFOS Pumps Corporation
17100 West 118th Terrace
Olathe, Kansas 66061
Phone: +1-913-227-3400
Telefax: +1-913-227-3500

Usbekistan
Представительство ГРУНДФОС в
Ташкенте
700000 Ташкент ул.Усмана Носира 1-й
тулик 5
Телефон: (3712) 55-68-15
Факс: (3712) 53-36-35

96477556 0609	320
Repl. 96477556 0405	